

Type "N"

## STATIC MIXERS

The standard Type "N" Static Mixers employ a simple design to provide the ultimate in mixing. Each unit achieves high mixing efficiency through multiple-action mixing. The liquid and additives are injected upstream of the static mixer and mixed through equal division, re-division, and rotational mixing which enhances turbulence and mixing. Typical mixing application includes mixing water or chemicals in Water and Wastewater Treatment Plants, Chemical Plants, Oil Refineries, Oil & Gas Plants, Food Processing, Pulp & Paper Mills. Standard Material of construction is Carbon Steel and Stainless Steel. Available in pipe sizes from 3/4" to 96" diameter.

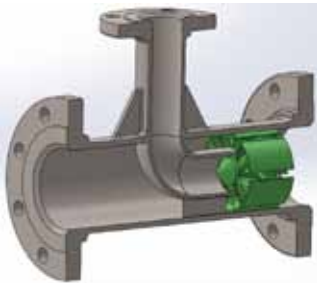

Type "SH"

## STEAM HEATERS

The Type "SH" Steam Heater is a very high heating efficiency device (up to 99%) due to direct steam injection into the process line. No moving parts, low capital cost, minimize noise and vibration and practically no annual maintenance cost required. Using a single modulating steam control valve, the Type "SH" Steam Heater could provide up to 10:1 turndown capability. Typical Steam Heating application includes direct injection of steam into water line to produce hot water in Chemical Plants, Oil Refineries, Oil & Gas Plants, Food Processing, Mining, Pulp & Paper Mills for the heating of paper pulp flow steams. Standard Material of construction is Type 316/L Stainless Steel. Available in pipe sizes from 1" to 36" diameter.

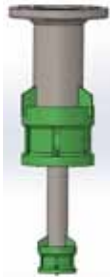

Type "TH"

## TANK HEATERS

The Type "TH" Tank Heaters is custom-engineered for direct injection of steam into a tank containing water/liquid. No moving parts, no noise, and no vibration. Each unit employs 2 specially designed mixing modules to equally disperse the steam inside the tank. Typical Steam Heating application includes direct injection of steam into the tank to produce hot water in Chemical Plants, Oil Refineries, Oil & Gas Plants, Food Processing, Mining, Pulp & Paper Mills for heating process water. Standard Material of construction is Type 316/L Stainless Steel. Available in pipe sizes from 2" to 12" diameter.

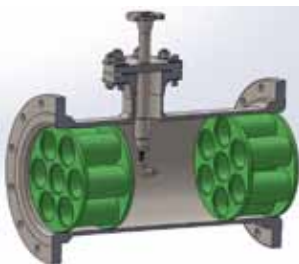

Type "DE"

## DESUPERHEATERS

The Type "DE" Desuperheater is custom-engineered for direct injection of water vapor in the form of uniform water droplets into a line containing superheated steam. Allows replacement of the spray nozzle without removing the desuperheater from the line. Each unit employs 2 specially designed mixing modules to instantaneously mix the water mist with the superheated steam in a mixing chamber. Typical desuperheater application includes Power Generation, Process Industries, Paper and Board Industry, Food Industry, Chemical & Pharmaceutical, Oil & Gas, Brewing & Distilling, Boiler & Turbine installation. Standard Material of construction is Type 316/L Stainless Steel. Available in pipe sizes from 3" to 60" diameter.

Note: MXR is not affiliated with Komax.

contact:

## MXR Technologies, LLC

40515 Green Oaks Dr. Temecula, CA 92592 USA

www.mxrtech.com

E-mail: info@mxrtech.com

Ph.: 1-951-303-4600 or 949-412-6525